

FOURTH STREET

FREIGHT ENTRANCE  
56' WIDE X 14.5' HIGH

FH  
M  
AW

REFRESHMENTS

REFRESHMENTS

REFRESHMENTS

FH

M

AW



FREIGHT ENTRANCE  
14' WIDE X 18' HIGH  
ALLEY #6



FREIGHT ENTRANCE  
14' WIDE X 18' HIGH  
ALLEY #7

MISSION STREET

RED LOADING DOCK

SHADED AREA MUST BE KEPT CLEAR AT ALL TIMES

CONCESSIONS

FREIGHT ENTRANCE  
14' WIDE X 18' HIGH  
ALLEY #6

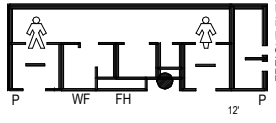

FREIGHT ENTRANCE  
14' WIDE X 18' HIGH  
ALLEY #5

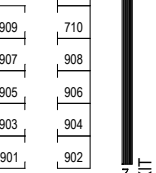
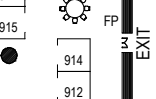
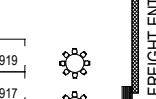
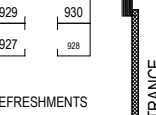
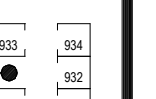
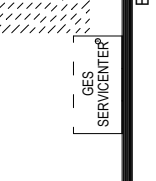
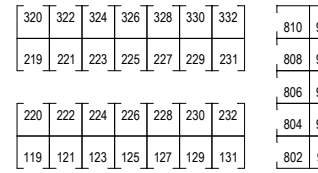
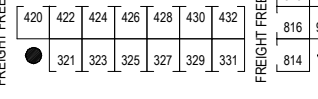
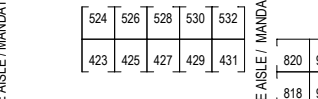
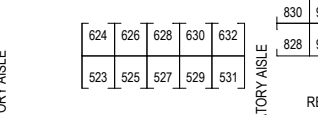
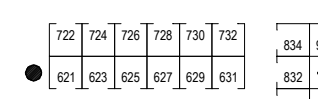
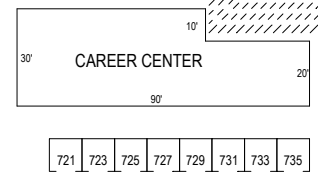
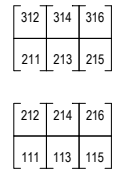
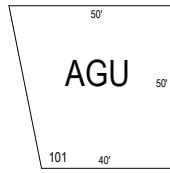
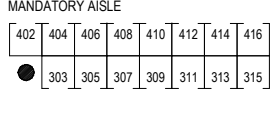
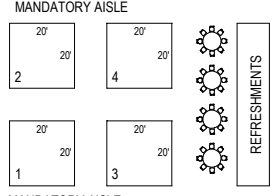
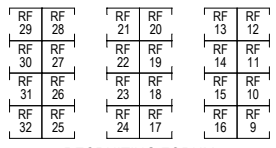
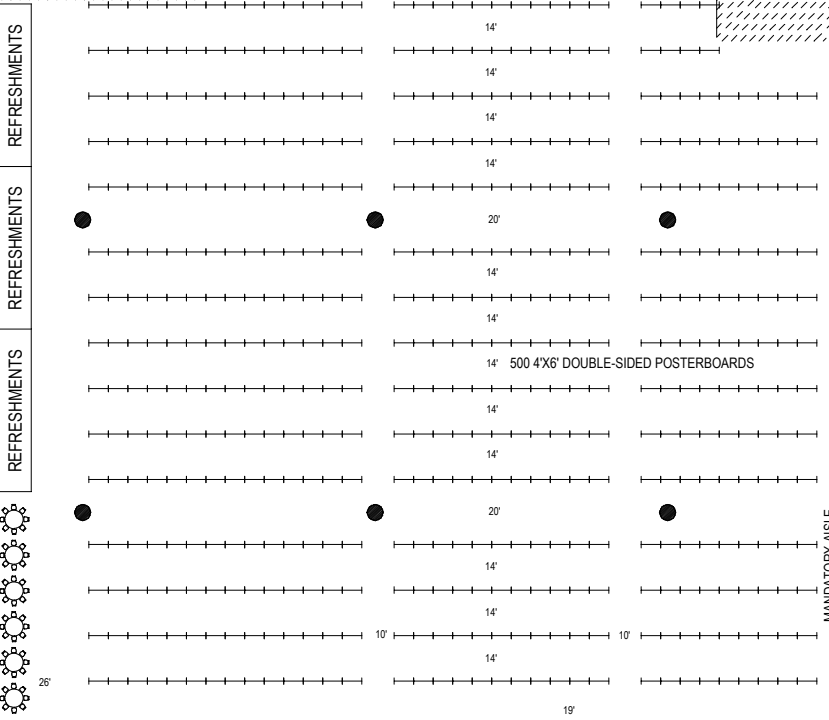

MEETING ROOM 135  
MEETING ROOM 134

HOWARD STREET

AGU 15' FACILITIES  
ENTRANCE

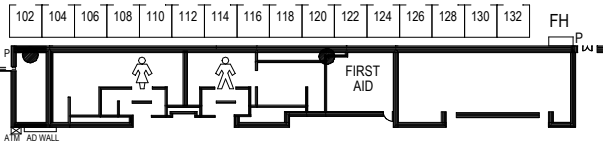

REFRESHMENTS

FH

M

AW

THIRD STREET

FREIGHT ENTRANCE  
56' WIDE X 14.5' HIGH

AMERICAN GEOPHYSICAL UNION 2001 FALL MEETING  
DECEMBER 11-13, 2001

166 EXHIBIT BOOTHS.  
BOOTH SIZE: 10'X10',  
32 10'X10' RECRUITING BOOTHS.  
NET SQ. FT.: 21,400.  
10' MINIMUM AISLE WIDTH.  
EXCEPTIONS NOTED ON PLAN.  
500 4'X6' POSTERBOARDS.



SAN FRANCISCO FIRE MARSHAL  
HAS FINAL APPROVAL OF ALL  
FLOORPLANS AND OTHER LAYOUTS.

COPYRIGHT © BY GES EXPOSITION SERVICES. ALL RIGHTS RESERVED.  
NO PART OF THIS PUBLICATION MAY BE REPRODUCED, STORED IN ANY  
RETRIEVAL SYSTEM, OR TRANSMITTED IN ANY FORM BY ANY MEANS  
- ELECTRONIC, MECHANICAL, PHOTOCOPIING, RECORDING, OR OTHERWISE -  
WITHOUT THE EXPRESS WRITTEN CONSENT OF GES EXPOSITION SERVICES.

PLAN PREPARED BY:  
**GES** EXPOSITION SERVICES  
A VIAD CORP. COMPANY  
333 OYSTER POINT BLVD  
SOUTH SAN FRANCISCO, CA. 94080  
PH: 650-615-4900 FX: 650-952-4248

DRAWN BY: BKF DB: ARRIS  
REV. 10/2/00 DR: 00 AGU  
REV. 8/6/01  
REV. 8/14/01  
REV.

HALL D  
MOSCONE CENTER  
SAN FRANCISCO, CA.