

1033	1031	1029	1027	1025	1023	1024
------	------	------	------	------	------	------



1032	1030	1028	1026	1024	1022	1020
933	931	929	927	925	923	921

1016	1014	1012	1010
917	915	913	911

932	930	928	926	924	922	920
833	831	829	827	825	823	821

916	914	912	910
817	815	813	811

832	830	828	826	824	822	820
733	731	729	727	725	723	721

814	812	810
717	715	713

726	724	722	720
627	625	623	621

716	714	712	710
617	615	613	611

632	630	628	626	624	622	620
533	531	529	527	525	523	521

616	517	511
-----	-----	-----

532	530	528	526	524	522	520
433	431	429	427	425	423	421



432	430	428	426	424
333	331	329	327	325

414	412	410
315	313	311

332	330	328	326
233	231	229	227

314	312
215	213
214	212
202	200
115	113

232	230	228	226	224	222	220
133	131	129	127	125	123	121

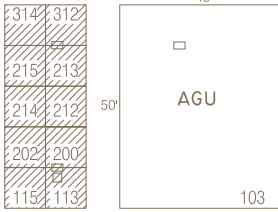

## POSTER SESSIONS

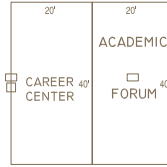

R26	R27	R28	R29	R30
-----	-----	-----	-----	-----

R31	R32	R33
-----	-----	-----

R34	R35
-----	-----

ACADEMIC SHOWCASE

R25	R24	R23	R22	R21
-----	-----	-----	-----	-----

R20	R19	R18
-----	-----	-----

R17	R16
-----	-----

R6	R7	R8	R9	R10
----	----	----	----	-----

R11	R12	R13
-----	-----	-----

R14	R15
-----	-----

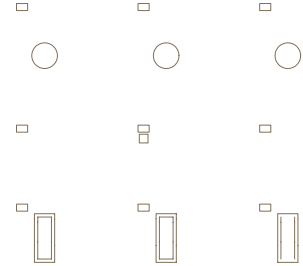
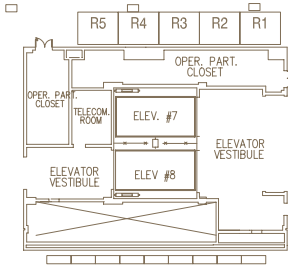

## SECOND FLOOR

## POSTER SESSIONS

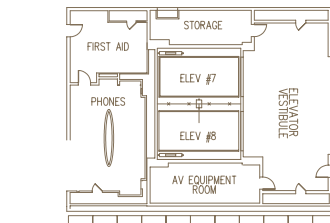

PRE-REGISTRATION

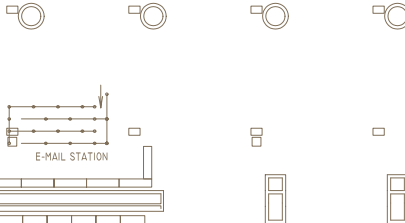

## FIRST FLOOR

## Moscone Center, West

San Francisco, California

### Booth Space:

Island:.....(20 x 20)

Premium:.....(shaded spaces)

Standard: .....(non-shaded spaces)

### Height Restrictions

Island booth: ...15'

Non-island booth: .....8'

*Note: Height limits are strictly enforced*